

FORTY3 WALL-HUNG WC NO RIM

FOS06BI

CE EN 997:2015

GLOBO

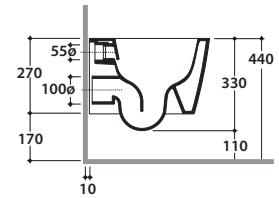
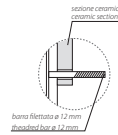
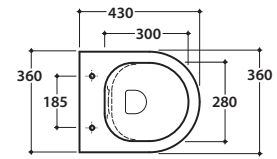

Ceramic antibacterial effect BATAFORM®



Bagno di Colore



SENZABRIDA®



Glazed product with CERASLIDE®



Drain 4/2,6 lt

Cod. **FOS06BI**

Wall-hung Wc No Rim 43.36 h33 cm. Drain 4 / 2,6 Lt. Fixing kit included. Weight 19 Kg

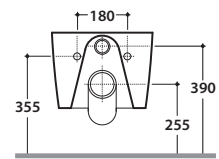

Seat-cover with hinge system to quick release



Antibacterial treatment on toilet seats in shiny white

Cod. **FOR22BI**

Removable duroplast seat-cover with soft-closing system. Weight 3,5 Kg

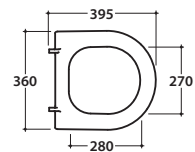
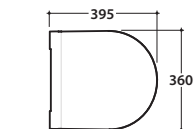

Cod. **VA132**

Flow reductor.



Cod. **PU001**

Acoustic and crash protection.



Cod. **F1002**

Fixing brackets for W/H sanitary. Weight 2,5 Kg

water label		
Average flushing volume (litres)		
Max. 3.5		3,38
Max. 4.5		
Max. 5.5		
Max. 6		
> 6		

www.europeanwaterlabel.eu