



SPARE PART LIST

Spare Part ItemCode	Item name.	PictureId	Price.	Curr.
6262.00026.03	Air trap (Plastic)			
6213.00002.33	M6*10 TEK NOKTA VIDA INOX			
6218.00002.17	M5 blind fastener self lock			
6213.00002.39	M5*10 stud bolt inox			
6262.00021.13	Water discharge hose Ø30x250 cm double sided			
6262.00027.06	Suction filter center part			
6214.00001.00	M3 INOX HEX NUT			
9099.01000.13	Hood Type Washing Tank heater 2000W 230V			
6215.00001.01	M5 INOX PUL			
6214.00005.00	NUT M5 S/S WITH DOMED CAP			
6215.00001.02	M6 washer supporting ring			
6214.00014.04	M5 hex nut with flange			
6214.00013.15	M8 nylon insert lock nut			
9099.00001.85	TERMOSTAT LIMIT RESETSIZ 75 C (MERCIMEK TIP) T1/11-75/55C			
2710.F0024.03	OBY 35/40 Wash Collector			
6215.00001.03	Ring M8			
6218.00002.17	M5 blind fastener self lock			
6226.00006.02	Gasket for air trap			
6259.00003.90	Blind stop with nut PG7			
6214.00001.03	M6 hex nut			
6606.00001.12	Grommet rubber Ø8x16			
6262.00021.18	Boiler Hose(inlet)			
2710.01000.18	BYM 1080 HOOD TYPE ALT SASE TOPLANMIS (25 LT)			
6213.00002.39	M5*10 stud bolt inox			
6212.00002.08	M6x15 hex head screw			
6221.00001.040	CLAMP 40-60MM			
6221.00001.050	Clamp 50x70			
6213.00001.01	M4x10 INOX PAN HEAD CROSS RECESSES SCREW			
6228.00001.110	Q RING 12,37*2,62			
6214.00014.01	M6 hex nut with flange			
6226.00021.13	Grommet for Drain Hose			
2710.11002.46	BYM 1080 HOOD TYPE YIKAMA MOTORU (OLYMPIA) BAGLANTI SACI			
6212.00002.16	M8*10 6K INOX CIVATA			
6262.00021.071	Washing pump connecting Hose			
6222.00027.01	CEKVALF PLASTIK DN20 (20MM 3/4" PLASTIK VENTIL ICIN)			
6262.00008.00	3/4 PLASTIC VALVE			
6262.00033.04	WASHING PIPE UPPER PARTS			
6226.00004.030	gasket , black (outer Q72/innerQ45/thickness:3mm)			
6262.00033.06	BYM 1080 YIKAMA BORUSU UST PARCASI SOMUNU			
6262.00041.03	NAVEL AXLES			
6262.00030.05	Ring of Water Canalize			
6238.00003.00	KABLO BAGI CV-100 2,5 (100 AD/PK)			
6227.00007.07	Hose blue Q6x1mm dosing system			
6215.00001.02	M6 washer supporting ring			
2710.01000.13	BYM 1080 HOOD TYPE KAPAK KALDIRMA BORU KOL TOPLANMIS (25 LT KAZAN)			
6214.00014.04	M5 hex nut with flange			
2710.F0025.03	Plastic Washing-Rinsing Elbow(Top)			
6213.00005.10	SAC VIDASI 3.5*16 YSB INOX			
6262.00028.07	Hood H type drain plug			
2710.F1000.03	1080 BOILER TANK (OZTI HOOD TYPE)			
6214.00014.01	M6 hex nut with flange			
6214.00013.10	M6 nylon insert lock nut			
6221.00001.030	CLAMP 32*50 MM			
2710.550.00250125.0.01	HOOD H TYPE KAPAK SUSTASI 25X142X4 LAZER ISLENMIS			
2710.550.00120030.0.01	Hood H type spacer for hinges			
6262.00041.04	YIKAMA MILI SAPKASI M8*10mm 6K INOX			
6228.00001.36	ORING Q35*2,5 mm			
6226.00010.01	Klinger gasket 1/2"			
6214.00013.15	M8 nylon insert lock nut			
6262.00032.05	Hook tie-rod for spring M10 partial threaded			
2710.11002.26	BYM 1080 HOOD TYPE UST KAPAK ARA BAGLANTI			
6214.00013.16	M5 nylon insert lock nut			
6213.00001.01	M4x10 INOX PAN HEAD CROSS RECESSES SCREW			
6231.00019.46	ROLE ZAMAN EMKO-BYM-01 (MAVI RENK - 50 / GIYOTIN)			
6262.00062.08	Washing tank heater cover			



Cumhuriyet Mah.Hadımköy Yolu Caddesi No:8 1Nolu Bağımsız Bölüm
Büyükcçekmece İstanbul VD: BüyükMükellefler VKN: 7080013433

Phone.: 00 90 212 8867800

Fax No: 00 90 212 8867809

Page 2

071M.11110.BB

HOOD TYPE DISHWASHER (MECHANICAL & HALF TANK) OBM 1080M PDRT Version No: V22.04

6262.00033.33	Washing&Rinsing Arm (Completely) plst.
6262.00027.07	Suction filter top part
6226.00004.07	Suction filter seal
6221.00001.020	Clamp 12x20
6262.00027.05	Suction filter lower part
6262.30666.013	Rinse-aid connection check valve
6262.00021.38	Hood type washing distribution hose
6262.00047.042	Handle support plate blank filling part-right
6214.00013.15	M8 nylon insert lock nut
6262.00003.20	KIZAK MAKARASI 1080 T/S
6262.00021.78	HORTUM BASKILI DURULAMA Y PARCA HOOD TYPE OBM 1080 (Rekorlu 570x630x570 mm) UZUN SASE
6262.00041.044	HOOD H TYPE YAY SUSTASI BURCU PASLANMAZ
6262.00003.060	Spring connection shaft
6215.00001.03	Ring M8
6262.00047.041	Handle spring plate blank filling part
6262.00003.06	Slide pulley bolt
6215.00001.03	Ring M8
6262.00058.07	Clamp assembly for hood pipe arm Q25 polyemid
6262.00047.05	Hood spring
6214.00013.15	M8 nylon insert lock nut
6214.00014.04	M5 hex nut with flange
2710.F1000.10	PANO TOPLANMIS BYM 1080 MEKANIK
6213.00002.11	M5x15 S/S COUNTERSINKING HEAD CROSS RECESS SCREW
6214.00014.01	M6 hex nut with flange
6262.00066.04	Bushing for spring hook tie-rod
6214.00002.03	M10 GALVENİZ SOMUN
6262.00022.13	Hood handle side guide
2710.50109.B02	BYM 1080 HOOD TYPE TERMOSTAT BAGLANTI SACI
6234.00001.037	TERMOSTAT AYNA+KAPAK 30-120 C (EGO)
6214.00014.03	M4 hex nut with flange
6214.00014.01	M6 hex nut with flange
6262.00039.00	PUL DIS 30 x IC 10 x 2 mm 430 KALITE
6259.00003.94	Blind stop with nut PG21
6213.00001.01	M4x10 INOX PAN HEAD CROSS RECESSES SCREW
6215.00001.03	Ring M8
6214.00013.18	M4 nylon insert lock nut
6234.00001.036	REZISTANS KOPRUSU SARI 1 1/2
6262.00062.01	Boiler tank heater cover
2710.00501.58	OBY 500 GOVDE TERMOSTAT PROB UCU
6214.00014.04	M5 hex nut with flange
6262.00067.41	KABLO GRUBU 1080 +EKO1000 T/S -TOPRAKLAMA
6262.00021.07	Pressure switch connection hose Q8*4mm
6216.00015.00	M4 serrated lock washer
6239.00001.00	KROSE 20*20MM YAPISKAN
6262.00071.37	KOMITATOR DUGMESI Q6 mm (YARIM KAZAN 1080 KNOB) SERIGRAFI BASKISI DAHIL GRI
2710.57885.01	BYM 1080 HOOD TYPE OZTIRYAKILER SEPET OTURAGI KOMPLE
6262.DBB50.00	BYM DUZ BARDAK BASKETI 500 x 500 mm
6262.CKB50.00	BYM CATAL KASIK BASKETI 500 x 500 mm
6262.00018.40	ETIKET BOILER 2*1 CM. (17)
6262.00800.016	KOLI BYM 1080 HOOD TYPE GIYOTIN MODEL 785x715x1481 DOPEL KOLI
6262.00018.18	Yellow label (Grounding)
6260.00090.89	ETIKET CIKARTMA 220-240 V NPE 50HZ 5*2 CM (47)
6238.00003.00	KABLO BAGI CV-100 2,5 (100 AD/PK)
6259.00003.10	STRAIN RELIEF PG 21 GRAY
6218.00002.15	M4 inox reduced head blind hex body fastener
6261.00014.320	Yellow Label (VOLTAGE)
2710.10002.21	Rear external cover
2710.1080H.05	Stainless Steel Strainer
6262.00007.00	Water Level Switch
6213.00001.01	M4x10 INOX PAN HEAD CROSS RECESSES SCREW
2710.11001.10	BYM 1080 HOOD TYPE ALT SASE MEKANIK ON PANEL YARIM KAZAN
6213.00002.33	M6*10 TEK NOKTA VIDA INOX
9099.00011.41	BUTON BLUE KALICILI MAVI POWER LOGOLU (LEDLI DUGME ONPOW / DAILYWELL KPB22-88P1-F11-
9099.00011.42	BLUE BUTTON KPB22
6214.00014.01	M6 hex nut with flange
6248.00017.01	KLEMENS NO 0 YANMAZ
6238.00003.01	CABLE TIE CV-150*3,6MM



071M.11110.BB

HOOD TYPE DISHWASHER (MECHANICAL & HALF TANK) OBM 1080M PDRT Version No: V22.04

6238.00005.00	CABLE TIE CV-250*3,6MM	
6251.00004.48	SIGNAL LAMB-ANEL S49	
6243.00002.01	MAKARON Q16MM SILIKON YANMAZ	
6213.00001.46	M5*10 RYSB INOX VIDA	
2710.00502.99	Handle cut over	
6213.00001.01	M4x10 INOX PAN HEAD CROSS RECESSES SCREW	
2EKO.PFBLYM.020	PALET FIRINLI BLYM - OBM 1080 - 78x71	
6011.00010.05	packing belt poliester 11*070 mm green	
6260.00091.122	LABEL COVER FILM TRANSPARENT 100*100 P.P	
6301.00012.12	A4'E 2AD ETIKET ÇIKARTMA REF NO:TW-2002 199.6MM*143.5MM	
2710.E1000.01	BYM 1080 ETIKET GRUBU MEKANİK (IHRACAT)	
6301.00012.10	A4 ETIKET TAM SAYFA (ÇIKARTMA) REF NO:2001 199,6*289,1MM	
6226.00004.040	GASKET-BLACK(EXT DIM Ø69/ DIM IN Ø55/K.4_5MM EPDM)	
2710.11049.50	BYM 1080 HOOD TYPE RÖZİSTANS SABİTLEME ve İSİ İLETİM SACI	
6212.00002.07	M6x10 hex bolt with flange	
9099.L80T7.5SX	BYM OLYMPIA 50 / GIYOTIN YIKAMA POMPASI (L80.T75SX)	
2710.01000.24	BYM 1080 HOOD TYPE ARKA SASE - YIKAMA KAZAN TOPLANMIS (25 LT)	
6214.00001.01	NUT M4	
6241.00007.02	cabl terminal	
6228.00001.35	Q RING 35MM*1,5MM	
2710.01000.25	BYM 1080 HOOD TYPE UST KAPAK TOPLANMIS (25 LT)	
2710.F0001.01	door type Magnet with cover	
6215.00001.01	M5 INOX PUL	
2710.10004.07	BYM MANYETİK SWITCH ve PROSESTAT BAĞLANTI SACI	
6232.00005.10	Magnetic switch	
6262.0TB50.00	BYM TABAK BASKETİ 500 x 500 mm	
6262.00021.12	3/4" Water Inlet Hose	
6011.00011.04	KOŞEBENT KARTON 40*40*4 mm / BOY 100 mm - BASKISIZ	
6260.00091.17	PRODUCT INTRODUCTION LABEL SILVERMAT 100*100 NON-PRINTED	
2710.50109.B02	BYM 1080 HOOD TYPE TERMOSTAT BAĞLANTI SACI	
2710.F1000.11	PANO TOPLANMIS BYM 1080 MEKANİK TAHLİYELİ	
6234.00001.019	TERMOSTAT 30-120°C FSTB WYG120S-061	
6234.00001.037	TERMOSTAT AYNA+KAPAK 30-120 C (EGO)	
6231.00019.46	ROLE ZAMAN EMKO-BYM-01 (MAVİ RENK - 50 / GIYOTIN)	
6234.00001.037	TERMOSTAT AYNA+KAPAK 30-120 C (EGO)	
6221.00001.121	Hose clamp 20-32 mm	
6231.00019.46	ROLE ZAMAN EMKO-BYM-01 (MAVİ RENK - 50 / GIYOTIN)	
2710.10003.01	BYM 1080 HOOD TYPE ELEKTRİK PANOSU SURGULU	
9234.00001.68	TERMOSTAT 170 C LIMIT (FSTB WYF170G-ZS4)	
2710.10001.10	BYM 1080 HOOD TYPE TAHLİYE POMPASI BAĞLANTI SACI	
6221.00001.120	CLAMP 25*42 MM	
6262.00021.163	Water discharge hose double sided 200cm	41
6262.00021.053	Drain pump connection hose	49
9099.DP020.052	Drain Pump DP020-052 with fixing bracket	50
2710.50108.B01	RINSE AID/DETERGENT DISPENSER CONNECTION PART	51
9999.B08RE.00	RINS-AID PUMP	52
9740.D3REG.00	DETERGANT PUMP	53
9099.R63T3.30	RINCING PUMP	68
6262.00021.18	Boiler Hose(inlet)	69
9099.01000.06	HEATING ELEMENT 9000 W IRCA INCOLAY 800 (1080-1500-2000 BOILER)	72
6221.00001.020	Clamp 12x20	77
6232.00027.00	Programme Switch	82
6232.00027.00	Programme Switch	82
9234.00001.68	TERMOSTAT 170 C LIMIT (FSTB WYF170G-ZS4)	84
9234.00001.68	TERMOSTAT 170 C LIMIT (FSTB WYF170G-ZS4)	84
6234.00001.019	TERMOSTAT 30-120°C FSTB WYG120S-061	85
6234.00001.019	TERMOSTAT 30-120°C FSTB WYG120S-061	85
2710.10003.01	BYM 1080 HOOD TYPE ELEKTRİK PANOSU SURGULU	94
2710.10003.01	BYM 1080 HOOD TYPE ELEKTRİK PANOSU SURGULU	94

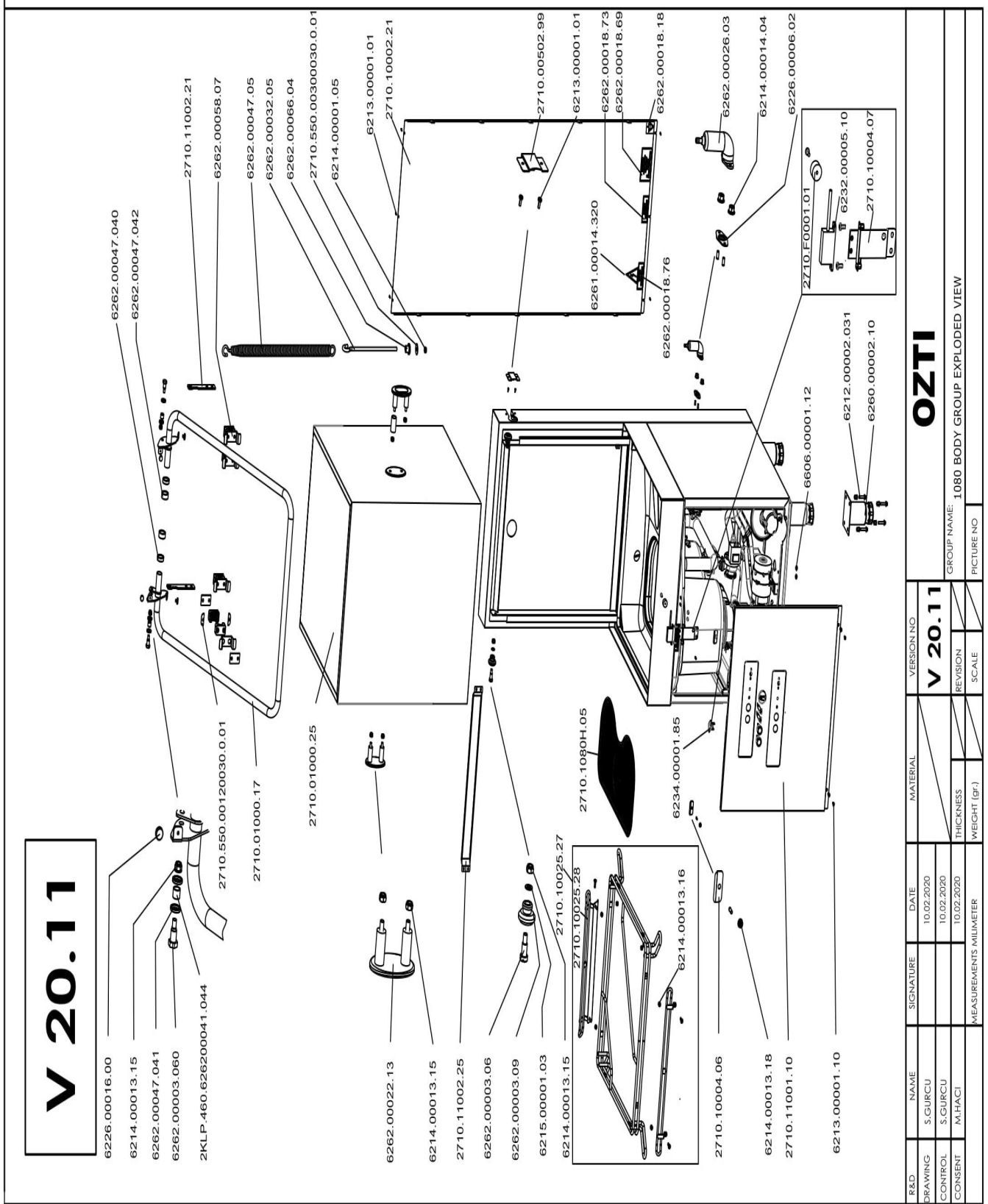

OZTI

GROUP NAME: 1080 BODY GROUP EXPLODED VIEW

PICTURE NO

R&D	NAME	SIGNATURE	DATE	MATERIAL	VERSION NO
DRAWING	S.GURCU		10.02.2020		V 20.11
CONTROL	S.GURCU		10.02.2020	THICKNESS	REVISION
CONSENT	M.HACI		10.02.2020	WEIGHT (GR.)	SCALE

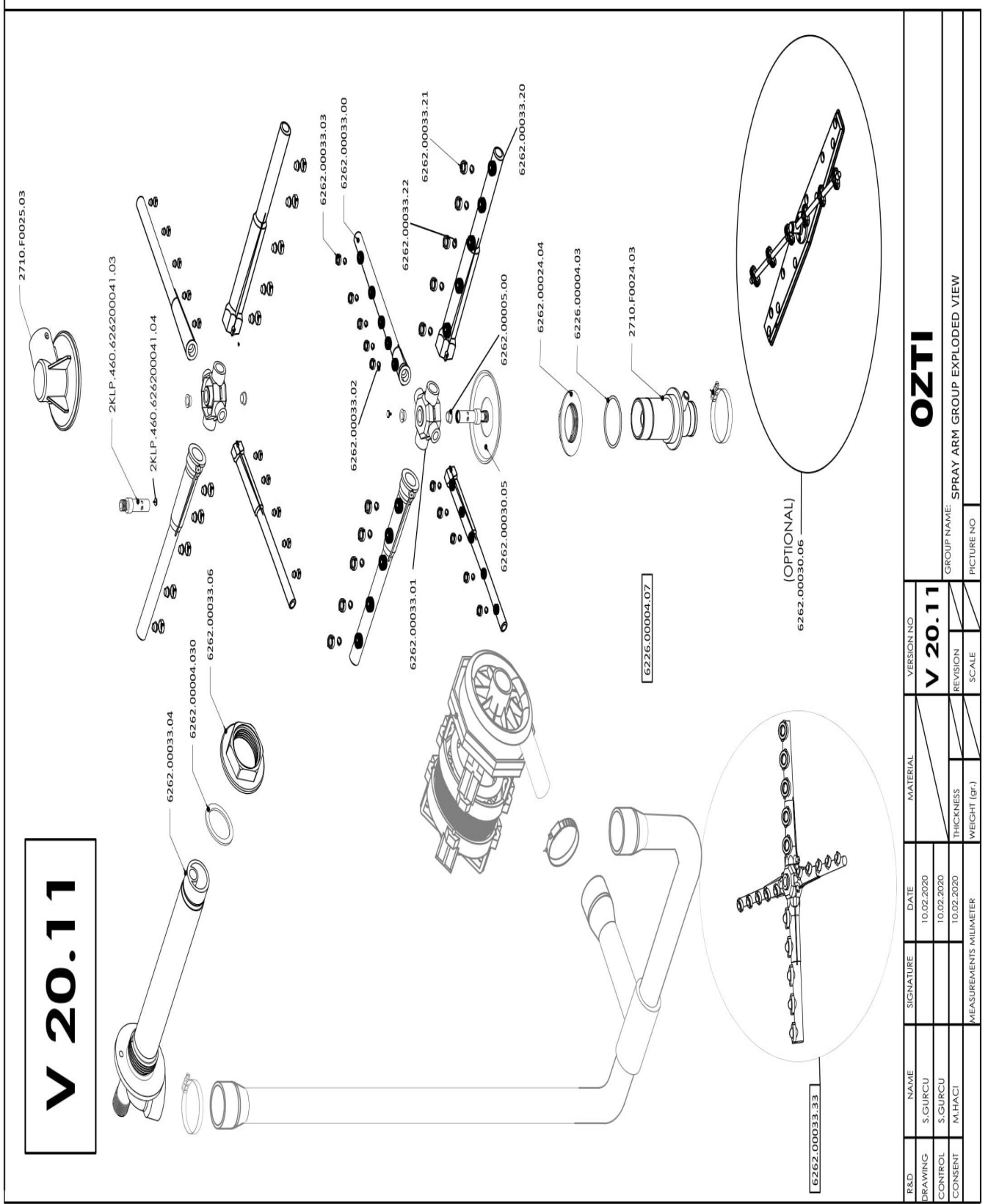

OZTI

GROUP NAME: SPRAY ARM GROUP EXPLODED VIEW
PICTURE NO:

R&D	NAME	SIGNATURE	DATE	MATERIAL	VERSION NO	
					REVISION	SCALE
DRAWING CONTROL	S.GURCU		10.02.2020		V 20.11	
CONSENT	S.GURCU		10.02.2020			
	M.HACI		10.02.2020			
				THICKNESS		
				WEIGHT (gr.)		
				MEASUREMENTS MILLIMETER		

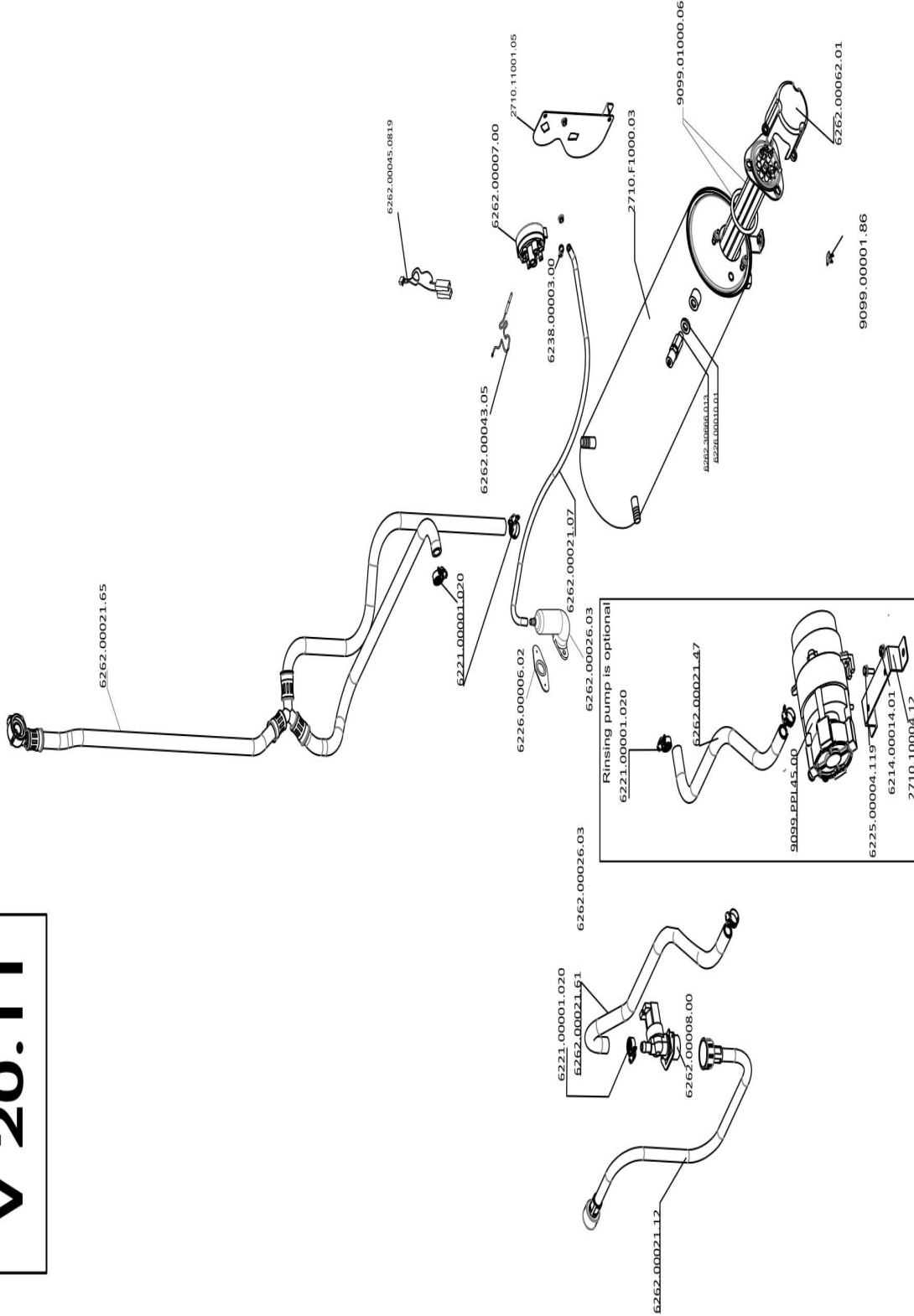

V 20.11

OZTI

VERSION NO
V 20.11

MATERIAL

DATE

SIGNATURE

NAME

R&D

10.02.2020

S.GURCU

S.GURCU

CONTROL

10.02.2020

M.HACI

M.HACI

CONSENT

GROUP NAME
RINSING GROUP EXPLODED VIEW

PICTURE NO

REVISION

SCALE

THICKNESS

WEIGHT (gr.)

MEASUREMENTS MILLIMETER

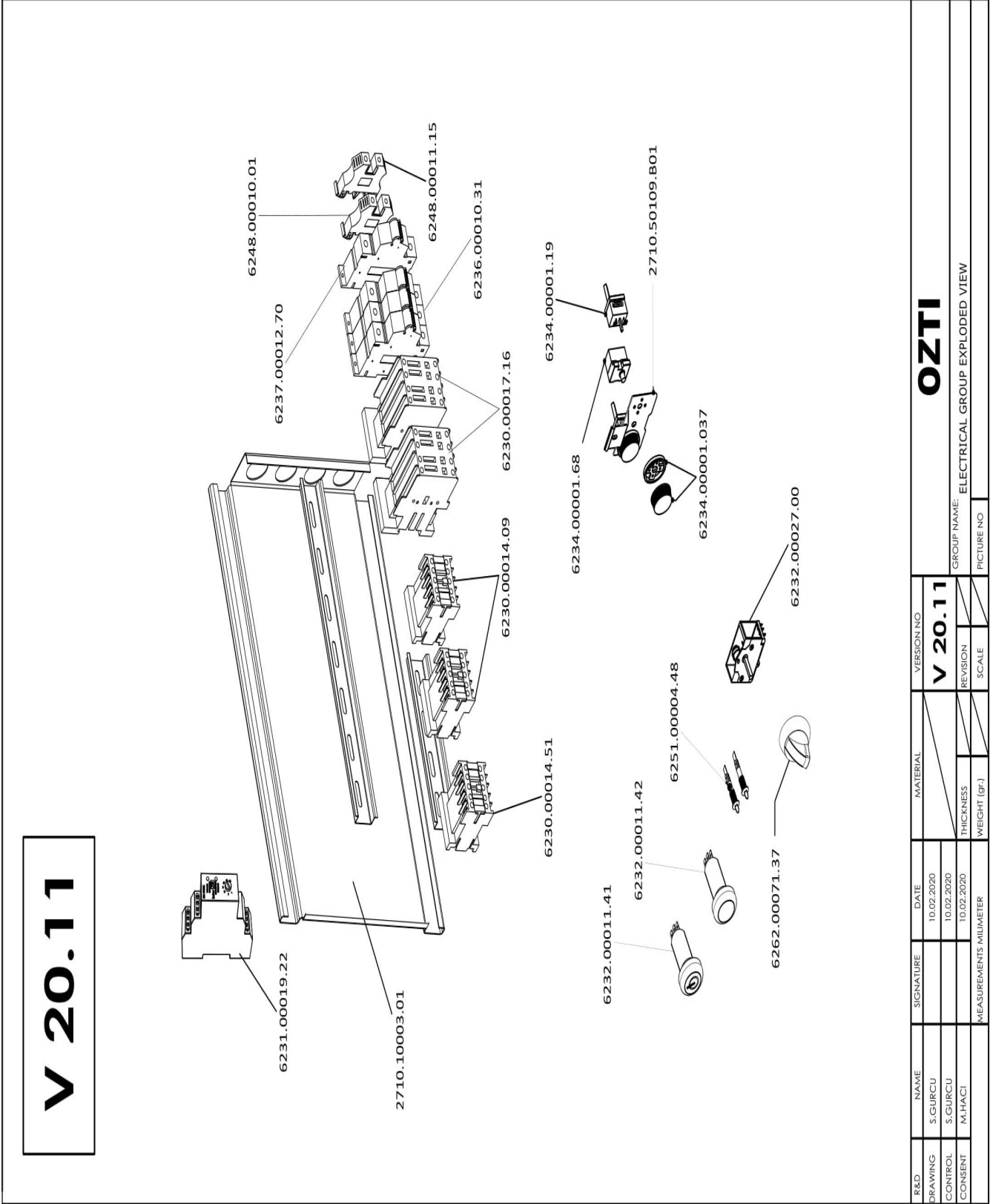

OZTI

VERSION NO
V 20.11

R&D	NAME	SIGNATURE	DATE	MATERIAL	VERSION NO	GROUP NAME	PICTURE NO
DRAWING	S.GURCU		10.02.2020		V 20.11	ELECTRICAL GROUP EXPLODED VIEW	
CONTROL	S.GURCU		10.02.2020	THICKNESS			
CONSENT	M.HACI		10.02.2020	WEIGHT (gr.)			
MEASUREMENTS IN MILLIMETER					SCALE		